



Buckland Road PO Box 366 Matamata NZ | phone (64) 7 888 9913 | facsimile (64) 7 888 7498 | office@hobbitontours.com | www.hobbitontours.com

conference facilities

The Shire's Rest has separate rooms available as outlined below. The centre is as adaptable as you need it to be.

room information

	Kaimai Room*	Alexander Room*	Wool Room*	Alexander Kaimai Room*
banquet*	72	58	50	140
u shape*	29	20	20	n/a
square*	70	40	30	n/a
classroom*	54	27	25	n/a
theatre*	100	55-60	54	160
half day*	\$70.00	\$60.00	\$40.00	\$120.00
full day*	\$125.00	\$100.00	\$70.00	\$200.00

* maximum numbers, per head, room

*price GST inclusive

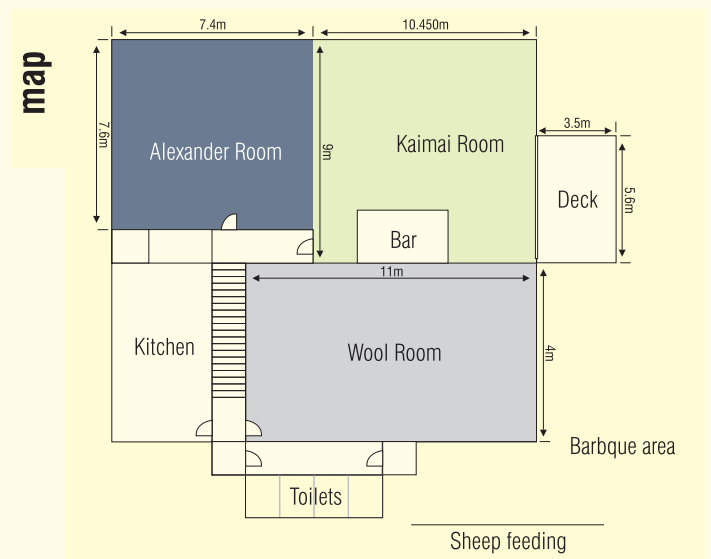

optional excursions (by prior arrangement only)

The Shire's Rest is set in a renovated woolshed on a 1,250 acre picturesque working sheep and beef farm with spectacular views across to the Kaimai Ranges. The farm was utilised for the filming of Peter Jackson's The Lord of the Rings Trilogy. An optional one and half hour tour of the Hobbiton Movie Set and Farm can be organised for your group at an additional cost. Tours depart from The Shire's Rest, courtesy transport provided.

complimentary items

- One standard white board
- Marker pens
- Flip chart
- Chilled water
- Mints
- Compact disc player

equipment hire

	price per day
34" television and video	\$30.00
Laptop computer with 'Office Power Point'	\$120.00
Sound system – wireless microphone (links to every room if desired)	\$25.00
Data projector and screen	\$180.00
Overhead projector and screen	\$30.00
Lectern	\$30.00
Large screen	\$20.00
Electronic whiteboard	\$100.00
Staging platforms (3-1200 x 2400)	per unit \$25.00

* all above prices are GST inclusive